

This drawing is copyright.  
Do not scale from prints.  
Contractors are to check all  
dimensions on site before  
ordering materials.

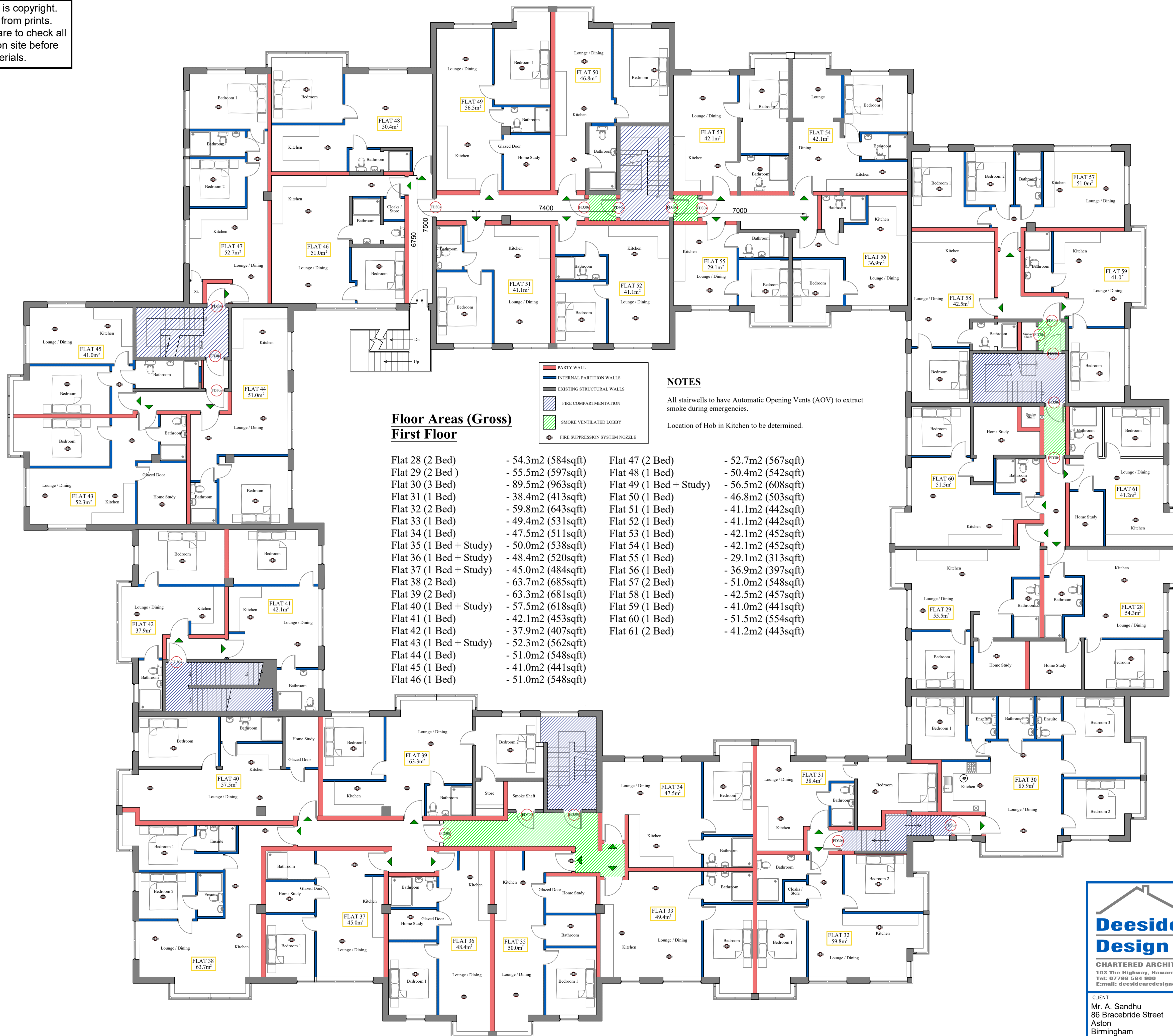

**Floor Areas (Gross)  
First Floor**

Flat 28 (2 Bed)	- 54.3m2 (584sqft)	Flat 47 (2 Bed)	- 52.7m2 (567sqft)
Flat 29 (2 Bed)	- 55.5m2 (597sqft)	Flat 48 (1 Bed)	- 50.4m2 (542sqft)
Flat 30 (3 Bed)	- 89.5m2 (963sqft)	Flat 49 (1 Bed + Study)	- 56.5m2 (608sqft)
Flat 31 (1 Bed)	- 38.4m2 (413sqft)	Flat 50 (1 Bed)	- 46.8m2 (503sqft)
Flat 32 (2 Bed)	- 59.8m2 (643sqft)	Flat 51 (1 Bed)	- 41.1m2 (442sqft)
Flat 33 (1 Bed)	- 49.4m2 (531sqft)	Flat 52 (1 Bed)	- 41.1m2 (442sqft)
Flat 34 (1 Bed)	- 47.5m2 (511sqft)	Flat 53 (1 Bed)	- 42.1m2 (452sqft)
Flat 35 (1 Bed + Study)	- 50.0m2 (538sqft)	Flat 54 (1 Bed)	- 42.1m2 (452sqft)
Flat 36 (1 Bed + Study)	- 48.4m2 (520sqft)	Flat 55 (1 Bed)	- 29.1m2 (313sqft)
Flat 37 (1 Bed + Study)	- 45.0m2 (484sqft)	Flat 56 (1 Bed)	- 36.9m2 (397sqft)
Flat 38 (2 Bed)	- 63.7m2 (685sqft)	Flat 57 (2 Bed)	- 51.0m2 (548sqft)
Flat 39 (2 Bed)	- 63.3m2 (681sqft)	Flat 58 (1 Bed)	- 42.5m2 (457sqft)
Flat 40 (1 Bed + Study)	- 57.5m2 (618sqft)	Flat 59 (1 Bed)	- 41.0m2 (441sqft)
Flat 41 (1 Bed)	- 42.1m2 (453sqft)	Flat 60 (1 Bed)	- 51.5m2 (554sqft)
Flat 42 (1 Bed)	- 37.9m2 (407sqft)	Flat 61 (2 Bed)	- 41.2m2 (443sqft)
Flat 43 (1 Bed + Study)	- 52.3m2 (562sqft)		
Flat 44 (1 Bed)	- 51.0m2 (548sqft)		
Flat 45 (1 Bed)	- 41.0m2 (441sqft)		
Flat 46 (1 Bed)	- 51.0m2 (548sqft)		

**NOTES**

All stairwells to have Automatic Opening Vents (AOV) to extract smoke during emergencies.  
Location of Hob in Kitchen to be determined.

REVISION	AMENDMENT	DATE
F	FLATS 28,29,53,60 & 61 AMENDED	09.07.21
E	FLATS 33-40 & 28,29,60,61 AMENDED	02.06.21
D	FLATS 30,31,38 & 40 AMENDED	16.04.21
C	VENTILATION LOBBIES AND FIRE SPRINKLER NOZZLES ADDED	05.01.21
B	GENERAL AMENDMENTS FOLLOWING CONSULTATION WITH FIRE STRATEGY CONSULTANT	01.01.21
A	FLATS 29, 30, 35, 36, 38 & 40 AMENDED	15.12.20

**Deeside Architectural Design Limited**  
 CHARTERED ARCHITECTS, TECHNICIANS, SURVAYORS  
 103 The Highway, Hawarden, Flintshire, CH5 3DL  
 Tel: 07798 584 900  
 E-mail: deesidearchdesign@gmail.com Website: deesidearch.co.uk

CLIENT: Mr. A. Sandhu, 86 Bracebride Street, Aston, Birmingham

DRAWING TITLE: Proposed Residential Development, Swan Court, Charles Edward Road, Birmingham

Date: Oct '20, Scale: 1:100

Drawing No.: 2020/25/PFF, Rev: F

PROPOSED FIRST FLOOR PLAN