

This drawing is copyright.
Do not scale from prints.
Contractors are to check all
dimensions on site before
ordering materials.

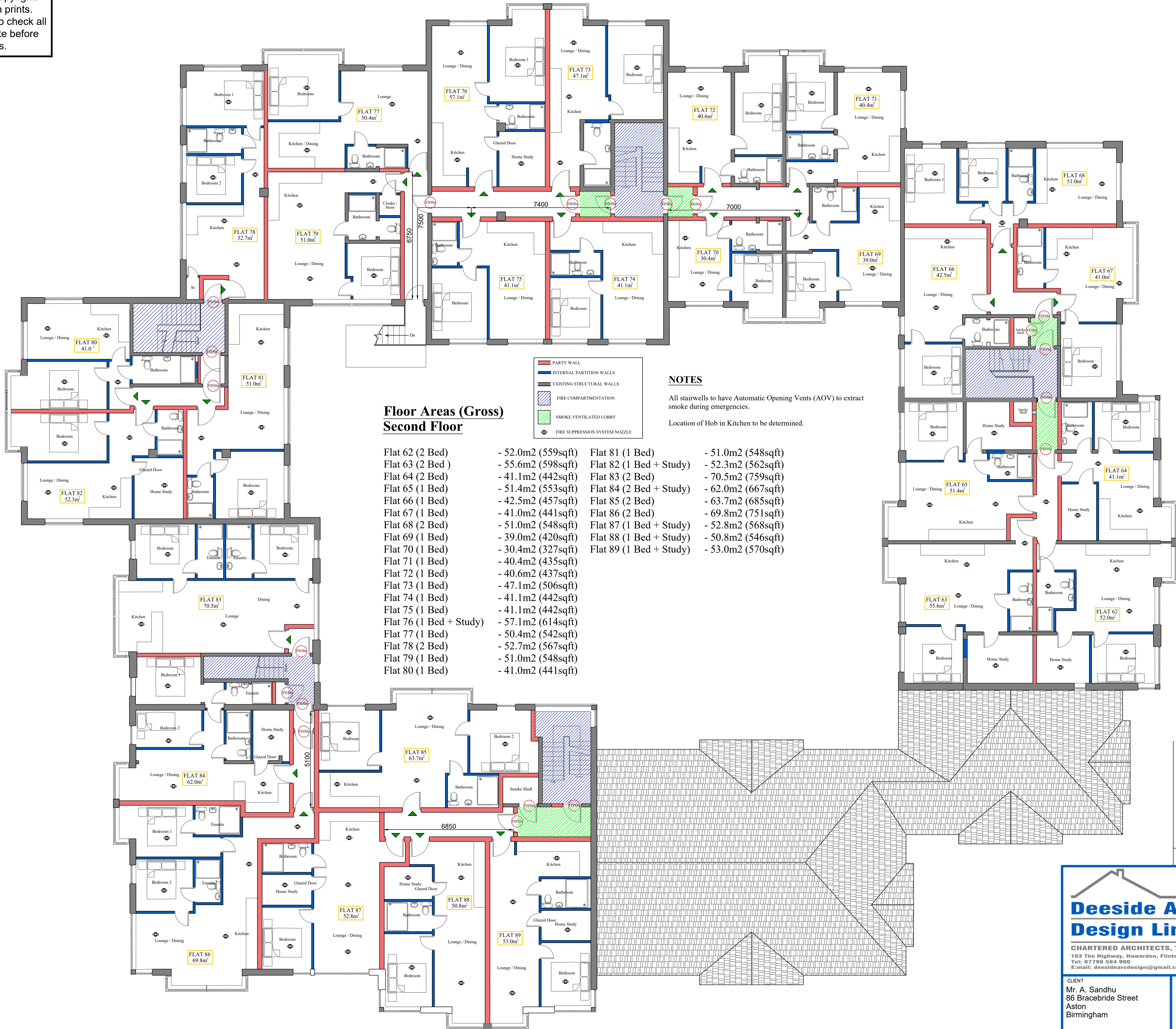

**Floor Areas (Gross)
Second Floor**

Flat 62 (2 Bed)	- 52.0m2 (559sqft)	Flat 81 (1 Bed)	- 51.0m2 (548sqft)
Flat 63 (2 Bed)	- 55.6m2 (598sqft)	Flat 82 (1 Bed + Study)	- 52.3m2 (562sqft)
Flat 64 (2 Bed)	- 41.1m2 (442sqft)	Flat 83 (2 Bed)	- 70.5m2 (759sqft)
Flat 65 (1 Bed)	- 51.4m2 (553sqft)	Flat 84 (2 Bed + Study)	- 62.0m2 (667sqft)
Flat 66 (1 Bed)	- 42.5m2 (457sqft)	Flat 85 (2 Bed)	- 63.7m2 (685sqft)
Flat 67 (1 Bed)	- 41.0m2 (441sqft)	Flat 86 (2 Bed)	- 69.8m2 (751sqft)
Flat 68 (2 Bed)	- 51.0m2 (548sqft)	Flat 87 (1 Bed + Study)	- 52.8m2 (568sqft)
Flat 69 (1 Bed)	- 39.0m2 (420sqft)	Flat 88 (1 Bed + Study)	- 50.8m2 (546sqft)
Flat 70 (1 Bed)	- 30.4m2 (327sqft)	Flat 89 (1 Bed + Study)	- 53.0m2 (570sqft)
Flat 71 (1 Bed)	- 40.4m2 (435sqft)		
Flat 72 (1 Bed)	- 40.6m2 (437sqft)		
Flat 73 (1 Bed)	- 47.1m2 (506sqft)		
Flat 74 (1 Bed)	- 41.1m2 (442sqft)		
Flat 75 (1 Bed)	- 41.1m2 (442sqft)		
Flat 76 (1 Bed + Study)	- 57.1m2 (614sqft)		
Flat 77 (1 Bed)	- 50.4m2 (542sqft)		
Flat 78 (2 Bed)	- 52.7m2 (567sqft)		
Flat 79 (1 Bed)	- 51.0m2 (548sqft)		
Flat 80 (1 Bed)	- 41.0m2 (441sqft)		

NOTES

All stairwells to have Automatic Opening Vents (AOV) to extract smoke during emergencies.

Location of Hob in Kitchen to be determined.

REVISION	AMENDMENT	DATE
F	FLATS 62-65 AMENDED	09.08.21
E	FLATS 62-65 & FLATS 84-89 AMENDED	02.06.21
D	FLATS 83, 84 & 86 AMENDED	16.04.21
C	VENTILATION LOBBIES AND FIRE SPRINKLER NOZZLES ADDED	05.01.21
B	GENERAL AMENDMENTS FOLLOWING CONSULTATION WITH FIRE STRATEGY CONSULTANT	01.01.21
A	FLATS 86 & 89 AMENDED	15.12.20

Deeside Architectural Design Limited
 CHARTERED ARCHITECTS, TECHNICIANS, SURVAYORS
 103 The Highway, Hawarden, Flintshire, CH5 3DL
 Tel: 07798 584 900
 E-mail: deesidearchdesign@gmail.com Website: deesidearch.co.uk

CLIENT: Mr. A. Sandhu, 86 Bracebride Street, Aston, Birmingham

DRAWING TITLE: Proposed Residential Development, Swan Court, Charles Edward Road, Birmingham

Date: Nov '20, Scale: 1:100

Drawing No.: 2020/25/PSF, Rev: F

PROPOSED SECOND FLOOR PLAN