

## Hartlebury Close, Dorridge

£160,000

🛏 2 🚿 1 🚗 1



**8 Hartlebury Close** - A first floor two bedroom maisonette situated in a quiet cul-de-sac location, benefiting from no upward chain, two double bedrooms, bathroom, lounge, re-fitted kitchen and communal gardens.

3 Union Road, Shirley, Solihull B90 3BT

sales • new homes • land • commercial • mortgages • auction

## Key Features

- A First Floor Maisonette
  - Re-Fitted Kitchen
  - Lounge
  - Communal Gardens
  -
- Two Double Bedrooms
  - No Upward Chain
  - Bathroom
  - Retirement Property For The Over 55's
  -

## First Floor

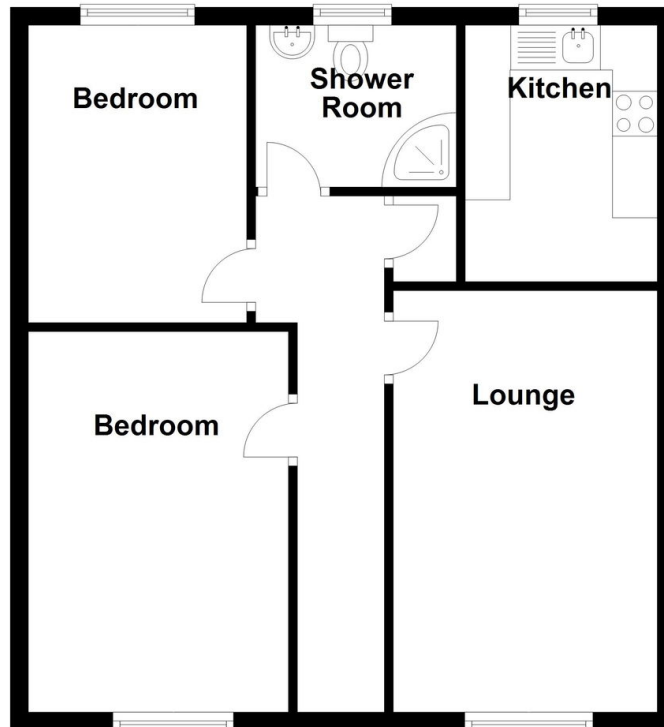

Total area: approx. 53.7 sq. metres (578.4 sq. feet)