



smarthomes

Aldershaws

Dickens Heath, Solihull

- A Beautifully Presented Two Bedroom Apartment
- Re-Fitted Kitchen & Re-Fitted Shower Room
- Spacious Lounge/Diner with Views Over Nature Reserve
- No Upward Chain, Garage & Two Parking Spaces

£185,000

Current EPC Rating - C
Current Council Tax Band - C





Property Description

A very well presented second floor apartment benefiting from no upward chain and offering views to rear over a nature reserve. With accommodation comprising a lounge/diner, re-fitted kitchen, two bedrooms, re-fitted shower room, communal gardens, garage and two parking spaces

Dickens Heath village offers a contemporary life style with a superb range of family homes and apartments, restaurants, offices, shops, medical surgeries as well as a local library, village hall and village green to provide that community lifestyle. Set within easy access to the M42 and train stations the village is ideal for families and commuters.



Rooms & Measurements

Lounge/Diner to Rear 4.42m x 3.35m (14'6" x 11'0")

Re-Fitted Kitchen to Rear 2.74m x 2.34m (9'0" x 7'8")

Bedroom One to Front 3.51m x 3.12m (11'6" x 10'3")

Bedroom Two to Front 2.51m x 1.96m (8'3" x 6'5")

Re-Fitted Shower Room 1.91m x 1.63m (6'3" x 5'4")

Garage & Parking

Tenure

We are advised by the vendor that the property is leasehold with approx. 99 years remaining on the lease, a service charge of approx. £2,330 per annum and a ground rent of approx. £50 per annum. We would advise all interested parties to obtain verification through their own solicitor or legal representative.

EPC supplied by Vendor.

Current council tax band – C

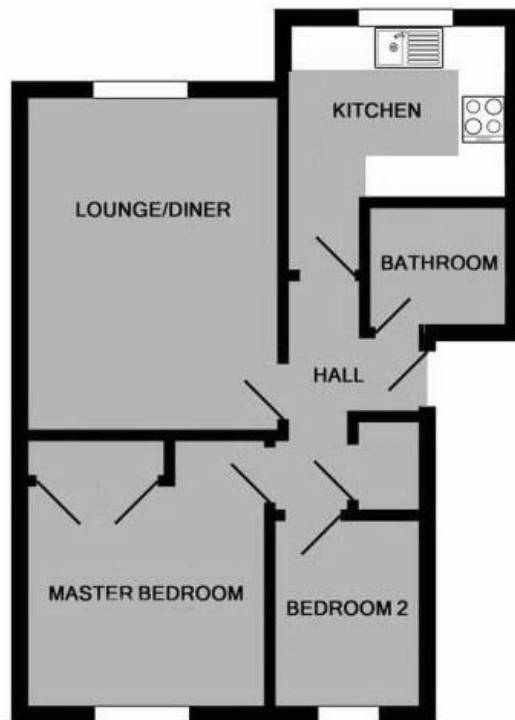

316 Stratford Road
Shirley
Solihull
B90 3DN

www.smart-homes.co.uk
0121 744 4144

Agents Note: Whilst every care has been taken to prepare these particulars, they are for guidance purposes only. We believe all information to be correct from the day of marketing however, we advise and recommend that your conveyancer and or surveyor verifies all information supplied. All measurements are approximate are for general guidance purposes only and whilst every care has been taken to ensure their accuracy, they should not be relied upon and potential buyers are advised to recheck the measurements.